

| REV. | ECN. NO.     | APPD.    |
|------|--------------|----------|
| A    | ECN141110005 | Fan Fang |

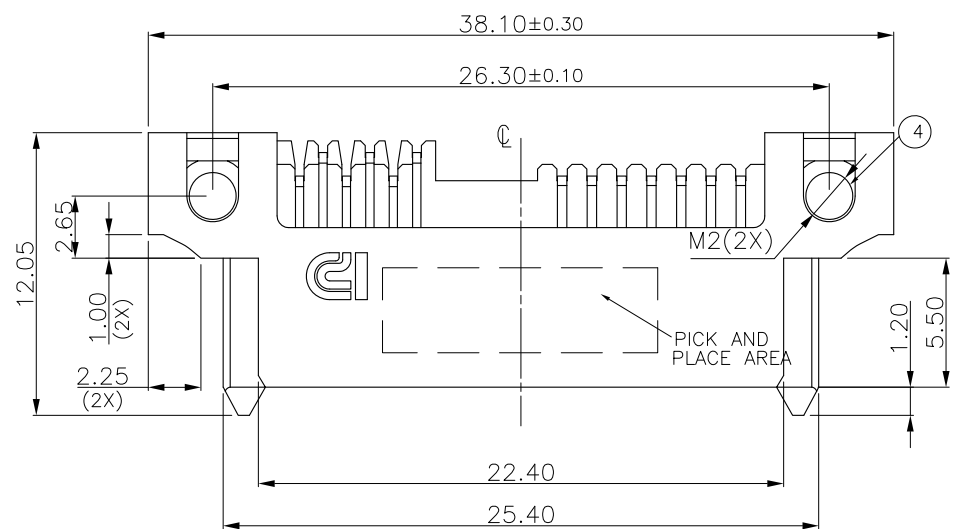

- NOTES:
- DIMENSION SHALL BE INTERPRETED PER ASME Y14.5M-1994.
  - ELECTRICAL CHARACTERISTICS
    - RATED CURRENT: 1.5A MAX.;
    - CONTACT RESISTANCE: 50 mOHMS MAX. INITIAL;
    - INSULATION RESISTANCE: 1000 MOHMS MIN.;
    - WITHSTANDING VOLTAGE: 500 VAC FOR 1 MINUTE MIN.;
  - MECHANICAL CHARACTERISTICS
    - DURABILITY: 500 CYCLES
    - VIBRATION: PASSED MIL-STD-202F, METHOD 201.
    - SHOCK: PASSED MIL-STD-202F, METHOD 213, CONDITION A.
  - ENVIRONMENT CHARACTERISTICS
    - OPERATION TEMPERATURE RANGE: -40°C TO +85°C.
  - PLEASE CONTACT DRAPHO SALES REPRESENTATIVE TO VERIFY PRODUCT DETAILS & AVAILABILITY.
  - HARMFUL MATERIAL CONTROL MEET DSQC0042.

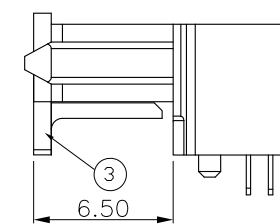
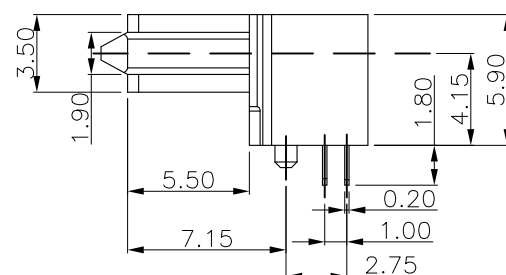
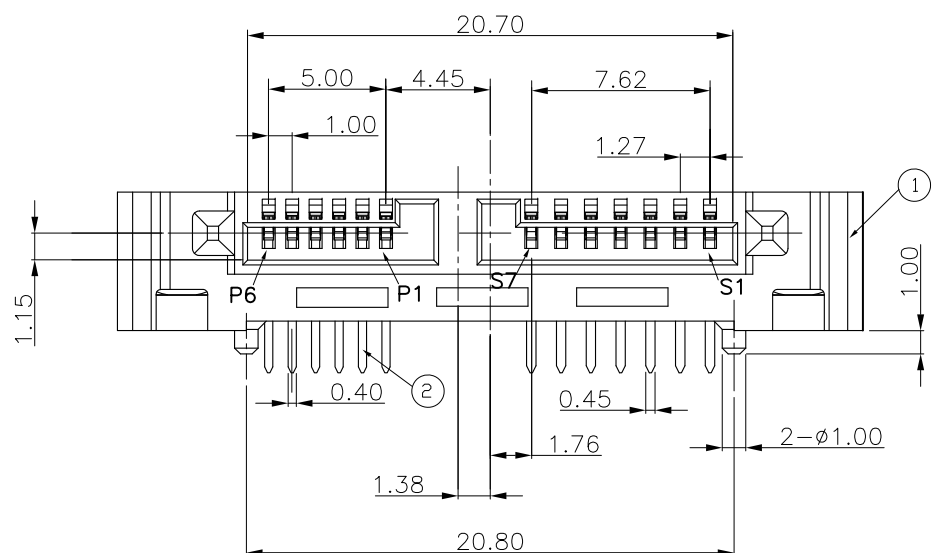

ADD CAP VIEW

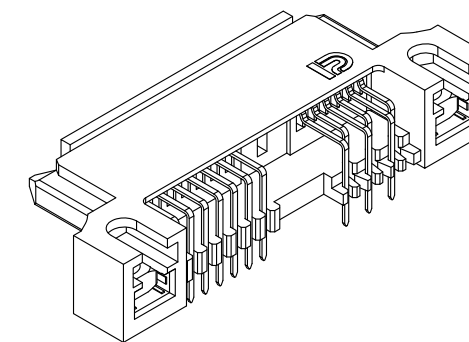

ISO VIEW

PART LIST

SA 1 S 013 6-420 1 H  
 SATA CONN. POS.NO. 013:13 POS. LEAD FREE & HALOGEN FREE  
 PACKAGE TYPE 1:TAPE AND REEL  
 CONTACT AREA PLATING 6: 1u" GOLD PLATING

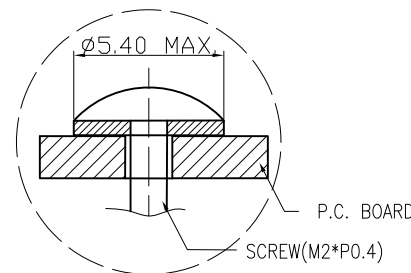
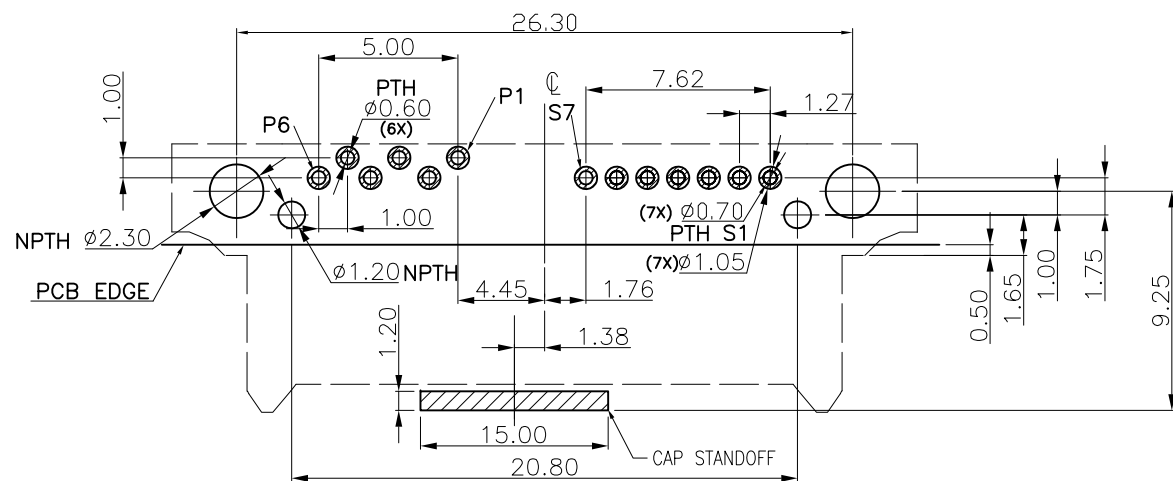

| 2    | NUT     | COPPER ALLOY     | 50u" NICKEL ALL OVER  | ④        |
|------|---------|------------------|---|----------|
| 1    | CAP     | HIGHTEMP-PLASTIC | UL94V-0, BLACK  | ③        |
| 13   | CONTACT | COPPER ALLOY     | 50u" NICKEL UNDER PLATING;<br>1u" GOLD PLATING ON CONTACT AREA;<br>80u" MATTE TIN PLATING ON SOLDER AREA. | ②        |
| 1    | HOUSING | HIGHTEMP-PLASTIC | UL94V-0, BLACK  | ①        |
| Q'TY | NAME    | MATERAIL         | FINISH  | ITEM NO. |

|                |   |  |                                       |
|----------------|---|--|---------------------------------------|
| UNITS: mm      | GENERAL TOLERANCE                           | APPROVE: Fan Fang                          | PART NO.(INTENDED USE) SA1S0136-4201H |
| DATE: 11/10'14 | X. ±0.30 X.* ±5.00*<br>.X ±0.20 .X.* ±3.00* | CHECKED: Daniel Yuan                       | TITLE: SATA CONNECTOR                 |
| SCALE: N/A     | .XX ±0.15 .XX* ±2.00*                       | DRAW: Adam Zhu                             | DRAWING NO.: 820-0000-0014            |
| SHEET: 1/2     | MATERIAL:                                   | <br>Drapho ELECTRONICS TECHNOLOGY CO., LTD | Highstar                              |
| REV.: A        | FINISH:                                     |  |                                       |



RECOMMEND PCB LAYOUT

TOLERANCE: +/-0.05  
 PCB THICKNESS: 1.00mm

| REV. | ECN. NO. | APPD. |
|------|----------|-------|
|      |          |       |

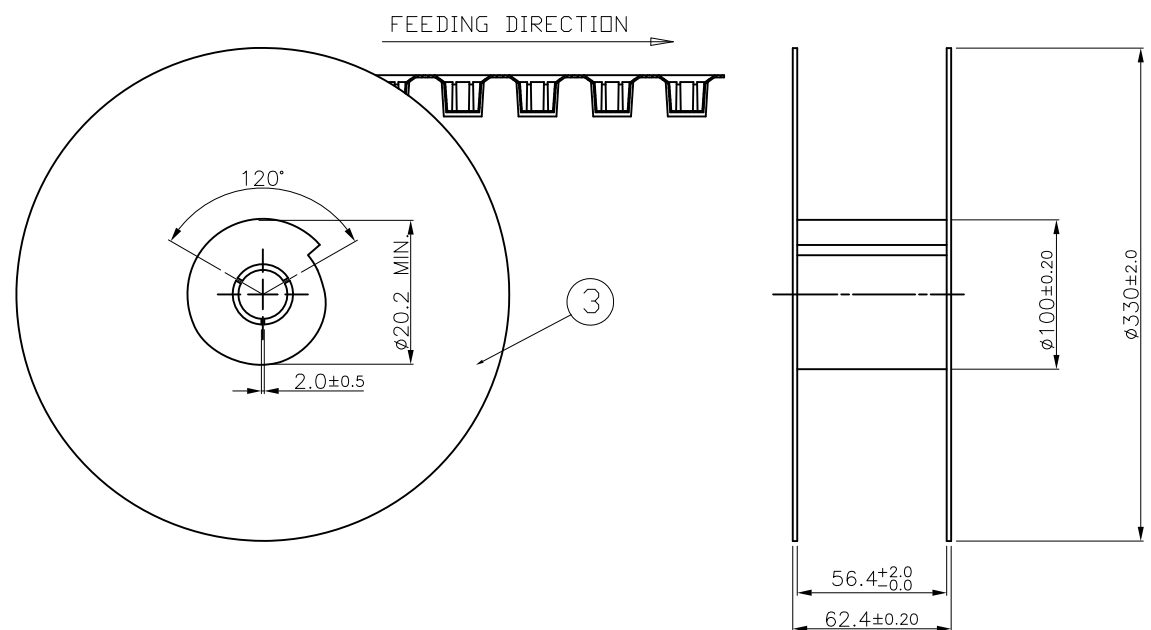

NOTES:

- 10 PITCHES CUMULATIVE TOLERANCE ON TAPE ±0.20mm.
- COVER TAPE PEELING STRENGTH: 0.13kgf MAX AT 300mm/MINUTE.

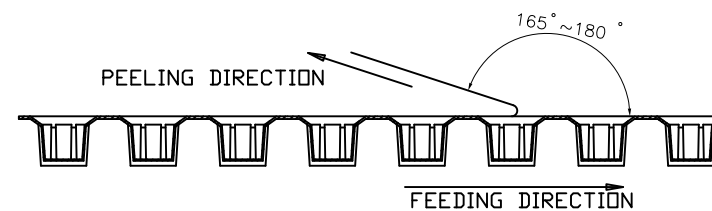

3. PACKING CAPACITY:

| P/N            | PCS/REEL | REEL/BOX | PCS/BOX |
|----------------|----------|----------|---------|
| SA1S0136-4201H | 350      | 5        | 1750    |

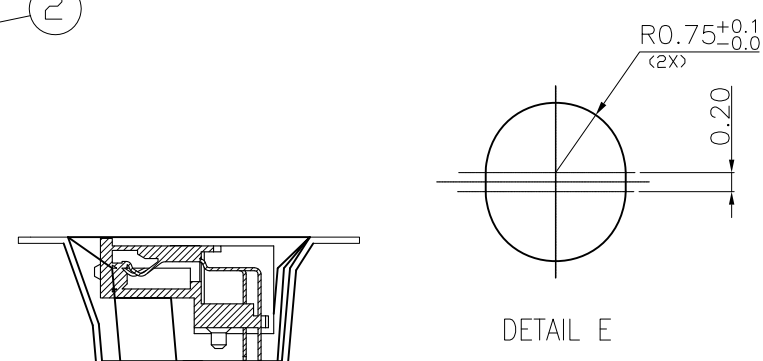
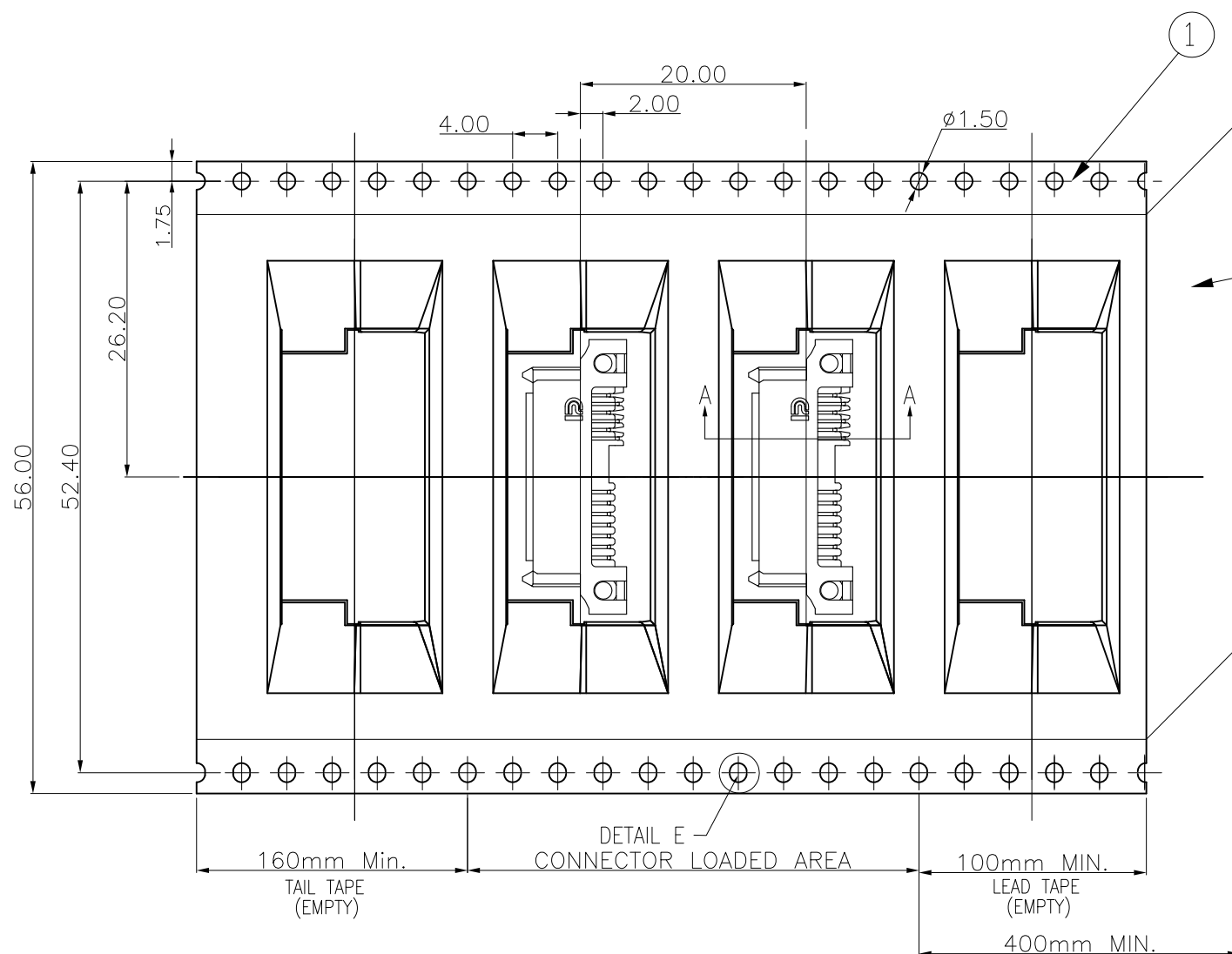

SECTION A-A  
SCALE 2:1

| ③    | REEL         |
|------|--------------|
| ②    | COVER TAPE   |
| ①    | CARRIER TAPE |
| ITEM | DESCRIPTION  |

|                   |   |  |  |
|-------------------|---|--|--|
| UNITS:<br>mm      | GENERAL TOLERANCE                         | APPROVE:<br>Fan Fang                               | PART NO.(INTENDED USE)<br>SA1S0136-4201H |
| DATE:<br>11/10'14 | X. ±0.30<br>.X ±0.20<br>.XX ±0.15         | CHECKED:<br>Daniel Yuan                            | TITLE:<br>SATA CONNECTOR                 |
| SCALE:<br>N/A     | X.* ±5.00*<br>.X.* ±3.00*<br>.XX.* ±2.00* | DRAW:<br>Adam Zhu                                  | DRAWING NO.:<br>820-0000-0014            |
| SHEET:<br>2/2     | MATERIAL:                                 | Highstar<br>Drapho ELECTRONICS TECHNOLOGY CO., LTD |  |
| REV.:<br>A        | FINISH:                                   |  |  |

